



Every-Member Meetings

Fall 2011



Mission Statement

**Our mission can be summarized as
"Preach, Teach, and Reach!"**

- **Preach** God's Word
 - "Preach the word; be prepared in season and out of season; correct, rebuke and encourage—with great patience and careful instruction." (2 Timothy 4:2)
- **Teach** our Children
 - "Train our children in the way they should go."
(Proverbs 22:6)
- **Reach** out to the world with the Gospel.
 - "Go into all the world and preach the good news to all creation." (Mark 16:15)



Goals of these meetings

- General update to members – information we'd like you to know about.
- Feedback requests
- Ask for your help, and encourage our members to attend worship services and Bible Classes, and participate in individual Bible study



Topics

- Updates:
 - current financial situation
 - Proposal by IDOT to buy a portion of the church & parsonage property
- Updates with Requests for Feedback:
 - Living Praise services
 - New Attendance/ Registration Cards
- Bible Study Opportunities
- Requests for Participation/ Survey:
 - Widow's Might
 - Ministries
 - Organizations
- Open Discussion



Financial Situation as of August

- Reminder: our 2011 budget was not balanced.
- Year to date, we are running at 115% of our budgeted income and only 95% of our budgeted expenses. Per our budget, we should have had a \$47,183 loss through August. In reality, we're only at a \$2,416 loss.
- 2011* Missions through July have been remitted.
- We've had to borrow \$14,305 from the line of credit. \$10,752 of that (75%) went towards reducing our mortgage. August donations were relatively strong, and we did not have to borrow further from the line of credit.

*We have not yet met our 2010 Missions Commitment.



September Financial Situation (September Status)

- Home State did not approve another year's extension of the line of credit (the line matured 8/31). Instead they approved a term loan for us to repay the \$50,000 principal balance. Monthly payments are \$338.13.
- We have ~\$25,000 in bills with only \$9,000 in the bank. With no line of credit or reserves to fall back on, the Church Council met on the September 27th to discuss our financial options. Council recommends the actions on next slide →



Council Recommendations

- A cash-out refinance on our existing LACE mortgage, increasing the balance from \$687,955 to \$800,000. We will use the extra cash to pay off Home State Bank and provide ~\$60,000 in reserves. With a reduction in the LACE interest rates, payments on the new loan will be lower than our current payment.
- The Treasurer will form a 2012 budget committee to review every expense of the church/school.
 - Committee will include an Elder, a member of the Ministry of Stewardship, a congregational member and a Faculty member
- We will conduct a pledge drive in an effort to balance the 2012 budget thus not having to use any reserves. This drive will include pledge cards and commitments from each member.



IDOT Offer

- IDOT wishes to purchase ~1 acre along the west side of our property
- Original (June) offer was \$51,000
 - \$36,500 for the land
 - \$14,500 for itemized damages
- We countered in August with \$152,000:
 - \$51,000 original offer, plus:
 - \$31,000 for trees & shrubs removed & to be planted to compensate for their loss
 - \$5000 to seek a variance
 - \$65,000 to upgrade the church's A/C system

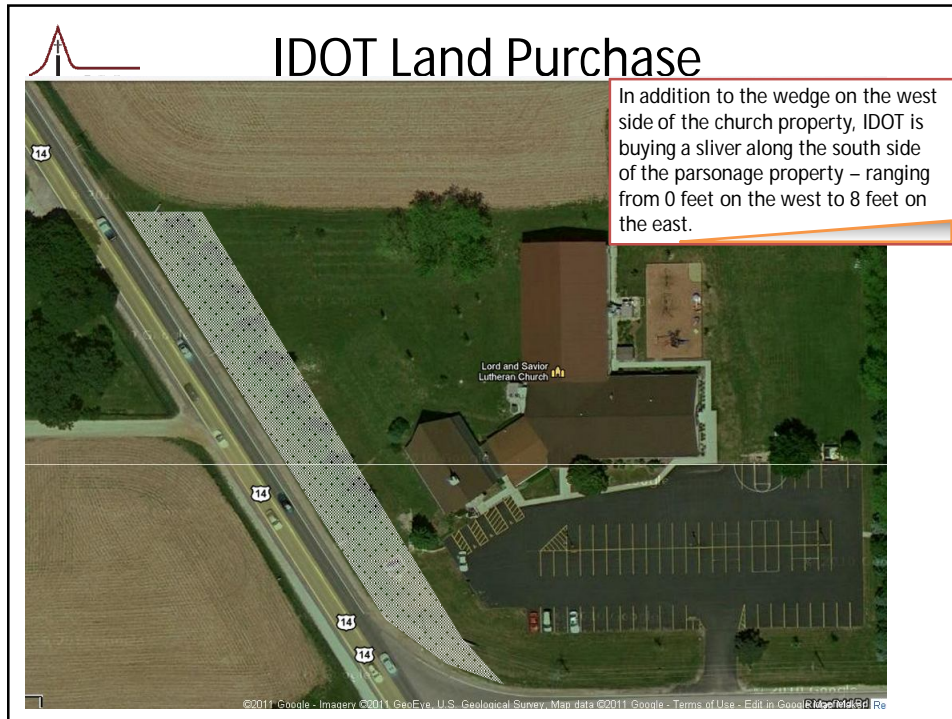

Current status of IDOT offer

- IDOT formally rejected our counteroffer on 12. September. Meeting Tuesday, 4. October to discuss response.
- Jim Stumpner met with the Bureau Chief of Land Acquisition, who indicated that some of our itemized damages are legitimate. He provided Jim with ideas of proper documentation.
- Plan to present our next response at Voters' Meeting in mid-October.



About "Living Praise" Services

- In response to requests for a "contemporary worship service," the "Living Praise" worship service was introduced in Fall 2010.
- "Living Praise" services are offered from October to May in the second (10:30am) service on the second Sunday of the month. They're also offered during the summer as and when the musicians are available.
- "Living Praise" worship services present familiar hymns, psalms, and new songs of worship, played in a refreshing and often upbeat style, by instruments other than the organ. A group of singers help lead the congregation in singing. As in all the worship services at Lord and Savior, the focus of the "Living Praise" service is to bring honor and glory to our Savior, and to proclaim the message of the Gospel.



"Living Praise" Feedback

- We'd like your feedback!
 - (Either during this meeting, or direct to Deb Carlovsky or Bob Swigart)
- Have you attended a Living Praise Worship Service?
- Did you enjoy it?
- What questions do you have?
- What suggestions or requests do you have?



Attendance/Registration Cards

- Quick and easy to fill out. Plan is to have pads made after trial period.
- Three key benefits:
 - Frees up elders to greet worshippers
 - Ensures we won't miss, or misidentify members
 - Ensures that we will identify visitors before Communion
- Comments?

Worship & Communion Registration
 Welcome! Please fill out a worship card for yourself (and your family), and pass it to the center aisle during the offering.

LORD & SAVIOR
 LUTHERAN CHURCH

Date: 9/1/2011 Family Name: Lentour
 List names of those attending today:
 First name(s): Marty
 Kate

Lord & Savior/ WELS/ ELS members taking communion - please check box(es)

Please check below if this is your first visit and provide your
 Address: _____
 City: _____ State: _____ Zip: _____
 Phone: (____) _____
 Email: _____@_____
 Home congregation: _____

Please use the other side for any comments, questions or prayer requests. Thanks!



Bible Study options

- **Sunday Morning Adult Bible Class:** Meets between services from Fall to Spring; meets after the 9:00a.m. service in the summer.
- **Sunday Morning Teen Bible Class:** Meets between services from Fall to Spring; open to teens, as well as pre-teens in the seventh and eighth grades.
- **Tuesday Morning Bible Class:** Open to all, this Bible Study meets at 9:00a.m. from Fall to Spring.
- **Women's Bible Study:** "The Heart of Jesus: Women in the Gospel of Luke" will begin Monday, September 19th at 7:00PM in the church fellowship hall.
- **Men's Bible Study:** meets on the third Saturday of each month (Fall to Spring) at 8:30a.m. Coffee and doughnuts provided!



Group Bible Study

- Our Sunday Bible studies have been using the “Prepared to Answer” series by Mark Paustian.
- Focus is on understanding, and being ready to answer the objections and questions that people bring up about Christianity (and especially confessional Christianity).
- Paustian’s books provide the average believer with a way to respond to questions and objections raised by non-Christians (or weak Christians), that doesn’t require a theological degree or knowledge of Greek & Hebrew.



Name that tune...





What's our reaction to this?

- What a stupid song!
- But God was (and is) one of us!
 - Cf 1. Timothy 2:5, Luke 24:39, John 1:14, Isaiah 9:6
- Is this how other people really think?
- If they do... that would explain a lot of people's objections about the Bible. They keep trying to make God over in their image.
- These studies start out by trying to understand the objection, then responding with a Bible story – and explaining how that Bible story answers the objection.



Sample Topics

(from Prepared to Answer)

- Where is the evidence that God even exists?
- If I work hard enough, God will accept me
- There are things I'll never be able to forgive
- Whatever happened to tolerance?
- With so many interpretations and denominations, who can say who is right?
- Why doesn't he answer my prayers?
- How can there be a good God when the world is such a bad place?
- Why is there so much pain in the world?



Simple Survey

1. What one thing would you be willing to do to assist Lord and Savior in its mission, that you aren't currently doing?
2. What ministry or church office would you be willing to support/ participate in?
3. What group or activity would you be interested or willing to participate in?
4. Would you be willing to support "The Widow's Might" if a member's need matched your abilities and availability?
5. What could Lord and Savior do or offer, to help you in your walk of faith?



Opportunities to serve: Ministries & Officers

- Ministry of Maintenance
- Ministry of Education
- Ministry of Outreach
- Ministry of Stewardship
- Ministry of Elders
- Congregational President
- Congregational Secretary
- Congregational Financial Secretary
- Congregational Treasurer



Activities & Groups

- **Worship Support:**
 - Greeters, Ushers, Videotaping, LCD presentations, Communion Set-up, Fellowship Committee
- **Music:**
 - Choir, Pianist, Instrumentalist/ vocal soloist
- **Education:**
 - Sunday School teacher/ substitute/ helper, VBS director/ teacher/aide, Children's Programs, other school assistance
- **Maintenance:**
 - Yard work, plumbing, carpentry, electrical, painting, cleaning
- **Youth Activities:**
 - Chaperones, group leaders, sponsors, mentors



Other Activities

- **Meals:**
 - Prepare and/or serve fellowship meals
 - Assist with Pancake breakfast, chili supper, etc.
 - Serve at funerals and/or weddings
- Participate in Church Cleaning rotation
- Participate in Phone Tree
- Prayer chain member
- Welcome new members
- In-house shepherding: contact person for your group or committee
- Serve as an Offering Counter
- Assist with Mailings, Posters, other publicity



“Widow’s Might” Program

- Vision: offer assistance to those members – most often our senior Christian sisters – who may need simple help around their homes.
- Areas of assistance:
 - Home/yard maintenance (anything from snow removal & leaf-raking to carpentry & plumbing).
 - Personal Property Maintenance (car, appliances, yard equipment, etc.)
 - Transportation: Provide transportation for appointments or to church, or run errands to pick up/ deliver food & medicine.
 - Consultation (with members who have professional expertise)



Member Participation

- What could Lord and Savior do, to help you in your walk of faith?
- What would be necessary for you to:
 - Attend church services more regularly (if you don’t at present)?
 - Attend one of the Bible Classes offered?
 - Read the Bible or devotional materials at home on a daily basis?



Other feedback/General Discussion

- Use of LCD Projector in services
- Visitor's booklet
- Church services, sermon topics, hymns...
- Church facilities, grounds, etc.
- General thoughts and concerns about the church or school
- Bible Class topics
- Anything else?



**Thank you for participating!
See you in church!**

And... please keep Lord and Savior in
your prayers!